

iNUKE NU4-6000

Ultra-Lightweight, High-Density 6000-Watt 4-Channel Power Amplifier

- Delivers 4 x 1500 Watts into 4 Ohms, 4 x 750 Watts into 8 Ohms and weighs less than 12 lbs. / 5.5 kg
- Ultimate reliability through revolutionary cool-running High-Density Class-D technology with "near-zero" thermal buildup
- Ultra-efficient switch-mode power supply for noise-free audio, superior transient response and low power consumption
- "Zero-Attack" limiters offer maximum output level with reliable overload protection
- Built-in Subwoofer/Satellite crossover for perfect subwoofer operation
- Detented and illuminated gain controls for precise level setting
- Precise 4-segment Signal and Limit LEDs to monitor performance
- XLR and ¼" TRS combination input connectors for compatibility with any source
- Professional twist-lock speaker connectors for ultimate reliability
- Independent DC, LF and thermal overload protection on each channel automatically protects amplifier and speakers without shutting down the show
- "Back-to-front" ventilation system prevents thermal buildup for reliable operation
- High-quality components and exceptionally rugged construction ensure long life
- Conceived and designed by BEHRINGER Germany

behringer.com



The powerful iNUKE NU4-6000 packs four 1500-Watt amplifiers into the space of one. Now you can run your stereo full range mains plus two separate monitor mixes with this one exceptionally lightweight, rack-mountable powerhouse. Or, you may want to operate your subwoofers in bridge mode (3000 W) and run you mid/high packs in mono biamp mode (2 x 1500 W). The highly versatile iNUKE NU4-6000 gives you options, and lots of them. Our revolutionary high-density Class-D technology combined with ultra-efficient switch-mode power supplies ensures these feather-light power amps will drive your rig effortlessly for many years to come.

Superb transient response

We spent years fine-tuning the high-density Class-D technology that gives the iNUKE Series its oomph. By carefully selecting transistors with extremely high slew rates and optimizing other proprietary parts of our circuitry, these amps react instantly to even the most demanding electronic bass impulses.

When this amazing amplifier technology is combined with our state-of-the-art switching-mode power supplies, these amplifiers provide tremendous punch. And because they are so much more efficient than conventional designs, they run cooler and don't require the massive heat sinks and heavy toroid transformers typically associated with their conventional counterparts.

Sublimely simple operation

The front panel controls and indicators provide your system's vital signs at a glance. After pressing the Power button, the Power LED lights to show the amp is ready for action. All channels feature positive-detent Gain controls with Signal LEDs that light when a signal is present, as well as clip LEDs to indicate when the signal is distorted and you need to reduce the input signal.

Continued on next page



iNUKE NU4-6000

The rear panel is just as elegant, with combo XLR and 1/4" TRS input connectors making the NU4-6000 compatible with virtually any source, balanced or unbalanced. Professional twist-lock speaker sockets are provided to ensure every drop of output power gets to your loudspeakers. The rear panel is also where you'll find the switches that enable the NU4-6000 to work in quad mono, dual stereo, or dual mono bridge mode. A built-in Crossover switch enables the amp to operate in biamp mode, sending low frequency content to passive subwoofers, while the high frequency output is channeled to full range loudspeakers.

4 Times the Value

Sporting not just one, but four 1500-Watt Class-D amplifiers in a single lightweight rack-mountable housing, an equally lightweight price tag, plus all the amenities a professional audio engineer could ask for, the BEHRINGER iNUKE NU4-6000 is the real deal! Designed to handle the most demanding audio applications, we back it with the best warranty program in the industry. Check one out today at your authorized dealer and experience the power of iNUKE.



Front Panel

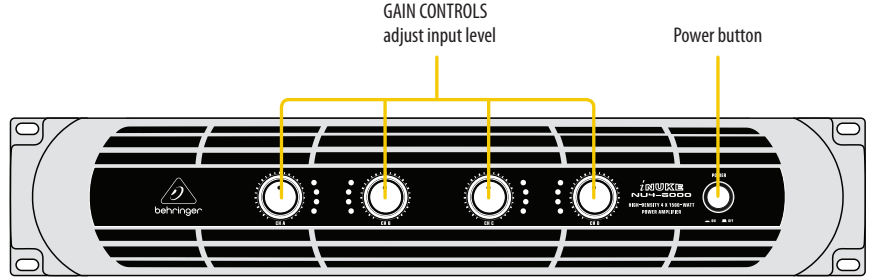

Rear Panel

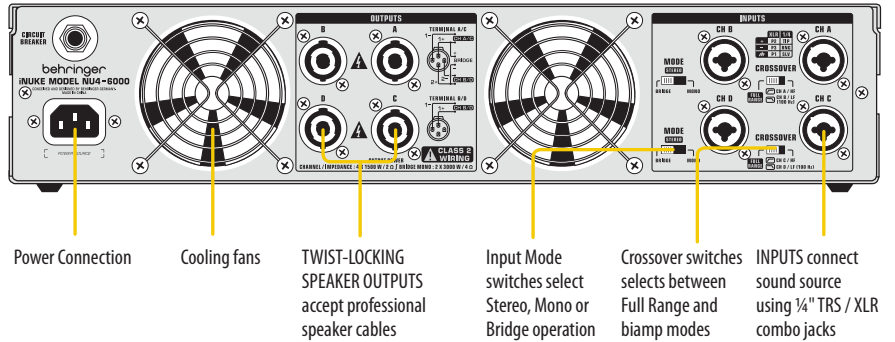

NU4-6000 in Stereo PA with Subwoofers

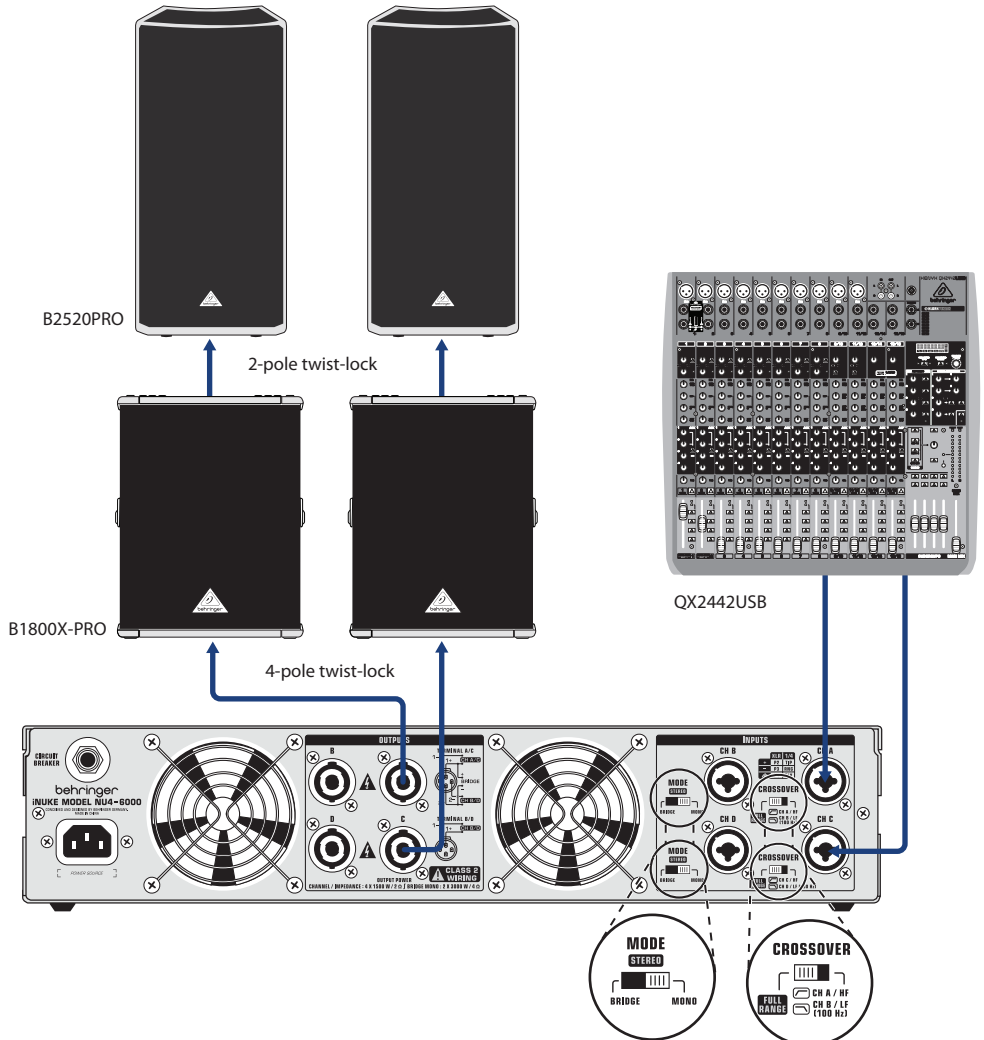

iNUKE NU4-6000

Stereo PA with Two Separate Monitor Mixes

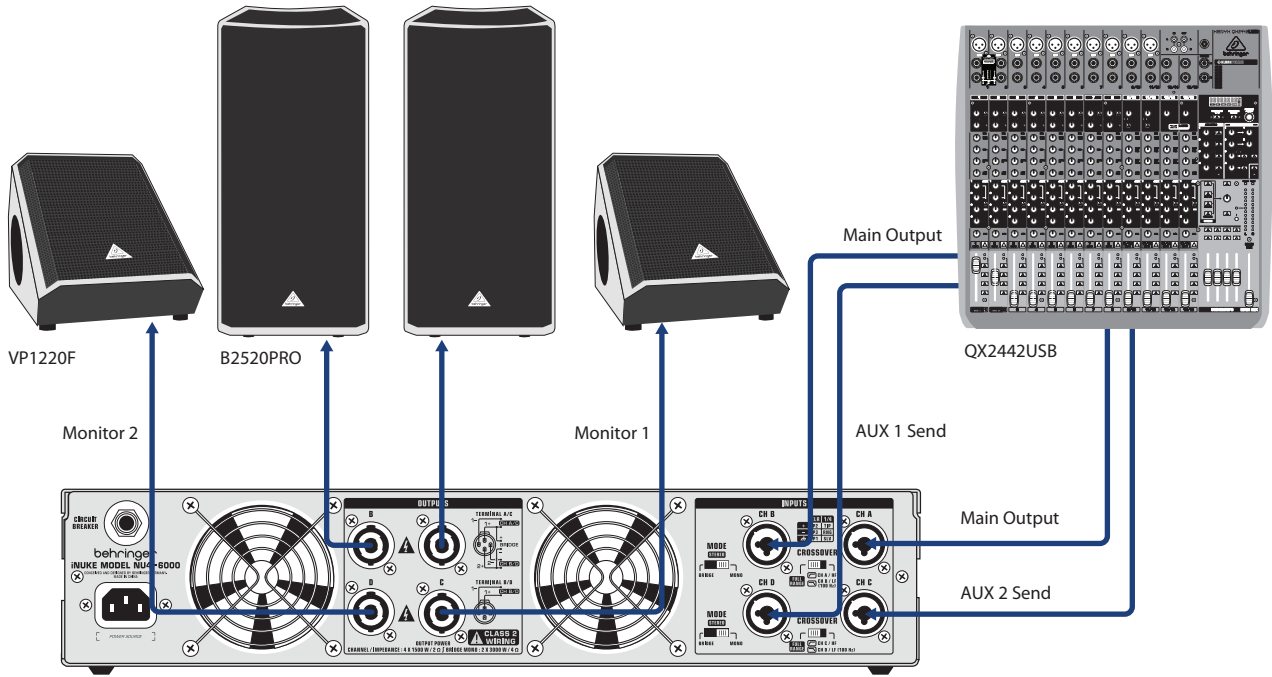

iNUKE NU4-6000

Specification

Output Power

Maximum Output Power

4-channel

8 Ω per channel 4 x 440 W

4 Ω per channel 4 x 860 W

2 Ω per channel 4 x 1600 W

Bridge connection

8 Ω per bridged pair 2 x 1600 W

4 Ω per bridged pair 2 x 3000 W

System

Controls

Front Power switch Gain controls (channels 1, 2, 3, and 4)

Rear 2 x Mode switch (bridge / stereo / mono)
2 x Crossover switch (fullrange / 100 Hz)

Indicators

Power Amber backlit illuminated gain controls

Limit (per channel) Red LED (0 dB, full scale)

Signal (per channel) Amber LED (-24 dB, -12 dB, -6 dB)

Connectors

Inputs 4 x combo jacks

Input impedance 10 k Ω unbalanced, 20 k Ω balanced

Outputs 4 x locking-style professional speaker connectors

Output circuit type Class-D

Distortion <0.2%

Frequency response 20 Hz to 20 kHz, +0 / -2 dB

Damping factor >120 @ 8 Ω

Signal-to-noise >100 dB

Circuit protection

Cooling Continuously variable speed fan
Back-to-front air flow

Amplifier protection Thermal and DC protection Stable into reactive or mismatched loads

Load protection On/off muting, DC-fault power supply shutdown

Power Supply, Voltage (Breaker)

USA / Canada 120 V~, 60 Hz, (25 A 250 VAC)

UK / Australia / Europe 220-240 V~, 50/60 Hz, (12 A 250 VAC)

Korea / China 220-240 V~, 50/60 Hz, (12 A 250 VAC)

Japan 100 V~, 50/60 Hz, (25 A 250 VAC)

Power consumption at 1/8 Max. non-clipped output @ 2 Ω 620 W

Power consumption at Max. attainable output @ 2 Ω 4800 W

Mains connector Standard IEC receptacle

Dimensions / Weight

Dimensions (H x W x D) appr. 3.7 x 19 x 12.2"
appr. 94 x 482 x 310 mm

Weight appr. 12.4 lbs / 5.6 kg

Please note these specifications are preliminary and conceptual in nature, and as such are subject to change as product development progresses. This information is supplied for market research purposes only and is not to be made public in any manner. This document is solely the property of The MUSIC Group, or one of its subsidiaries, and must be surrendered upon request of the owner.

For service, support or more information contact the BEHRINGER location nearest you:

Europe
MUSIC Group Services UK
Tel: +44 156 273 2290
Email: CARE@music-group.com

USA/Canada
MUSIC Group Services NV Inc.
Tel: +1 702 800 8290
Email: CARE@music-group.com

Japan
MUSIC Group Services JP K.K.
Tel: +81 3 6231 0454
Email: CARE@music-group.com

Technical specifications and appearances are subject to change without notice and accuracy is not guaranteed. BEHRINGER is part of the MUSIC Group (music-group.com). All trademarks are the property of their respective owners. MUSIC Group accepts no liability for any loss which may be suffered by any person who relies either wholly or in part upon any description, photograph or statement contained herein. Colors and specifications may vary from actual product. MUSIC Group products are sold through authorized fulfillers and resellers only. Fulfillers and resellers are not agents of MUSIC Group and have absolutely no authority to bind MUSIC Group by any express or implied undertaking or representation. This manual is copyrighted. No part of this manual may be reproduced or transmitted in any form or by any means, electronic or mechanical, including photocopying and recording of any kind, for any purpose, without the express written permission of MUSIC Group IP Ltd. ALL RIGHTS RESERVED. © 2012 MUSIC Group IP Ltd. Trident Chambers, Wickhams Cay, P.O. Box 146, Road Town, Tortola, British Virgin Islands.